

FOREST LAKES SOUTH

Black = Asphalt Paths
Green = Natural Surface Trails

Permitted uses include biking, hiking, jogging and mountain biking.
No motorized uses are allowed!

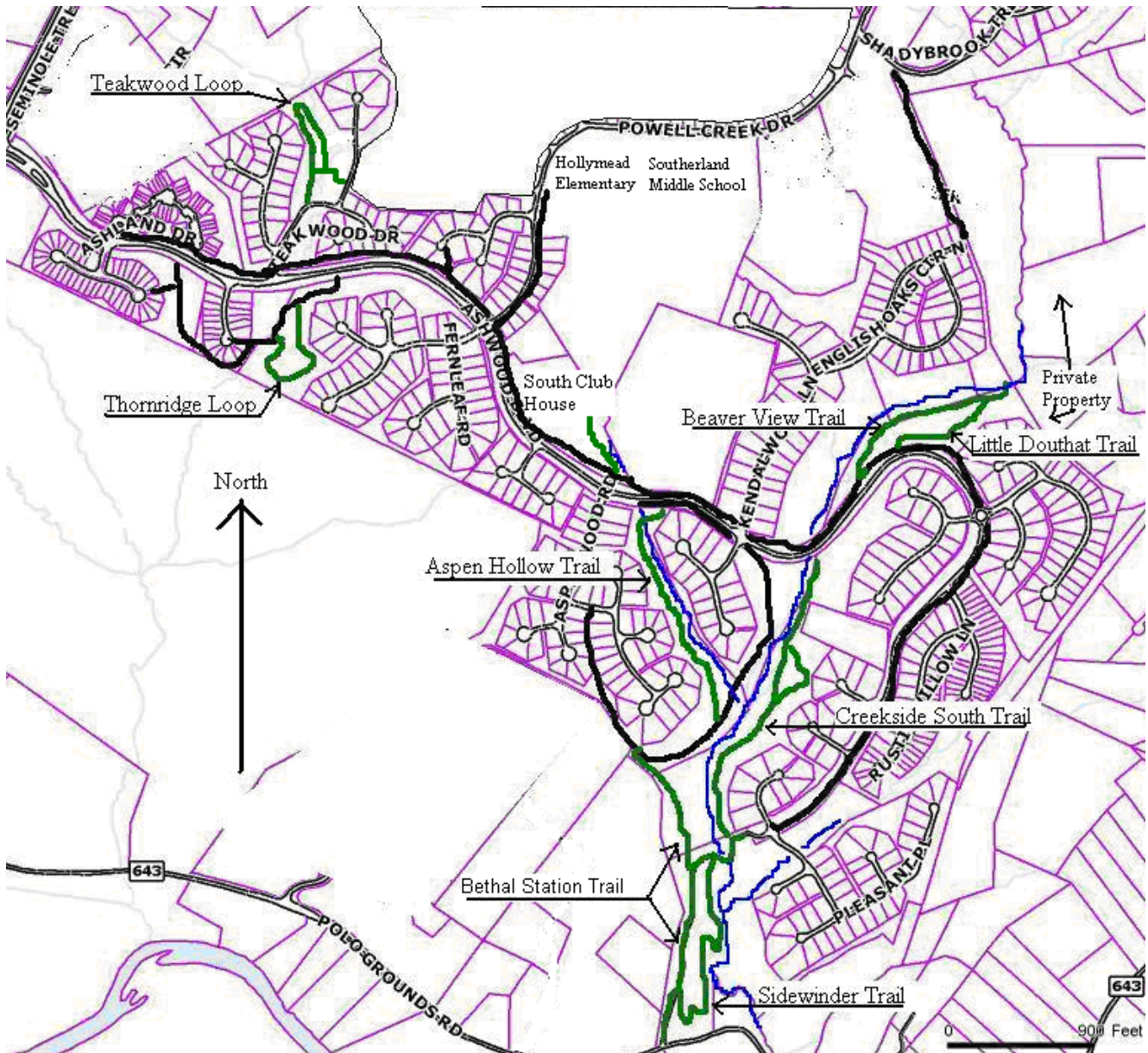

Paths and trails are for use by Forest Lakes Residents and Guests Only. **Use of paths and trails is at your own risk** as asphalt paths may have bumps, cracks, and uneven edges. Natural surface trails have uneven surfaces, rocks, roots, and other natural features typically found on rustic trails. Please be responsible and do not use natural surface trails when conditions are muddy, as damage to the trails may occur.

Note: Natural surface trails are volunteer maintained. To find out how you can help, please contact the Forest Lakes Property Manager.